

KANSAS CORPORATION COMMISSION  
OIL & GAS CONSERVATION DIVISION  
**APPLICATION FOR INJECTION WELL**

Form U-1  
July 2006  
Form must be Typed  
Form must be Signed  
All blanks must be Filled

Disposal ☒

Enhanced Recovery: ☐ Repressuring

☐ Waterflood

☐ Tertiary

Date: January 1, 2008

Operator License Number: 999999

Operator: Sample Oil, LLC

Address: 130 S. Market

Wichita, KS 67202

Contact Person: I.M. Sample

Phone: 316-337-6200

Permit Number: (to be assigned by KCC)

API Number: 15-207-99999

**Well Location**

SW NW SE, Sec. 22 Twp. 23 S. R. 14 ☒ East ☐ West

1650 Feet from SOUTH Section Line

2310 Feet from EAST Section Line

Lease Description: S/2 Sec 22 and SE/4 Sec 21-23S-14E

Lease Name: Smith Well Number: OWWO 'A' #1

Field Name: Cherokee Basin Coal Area

County: Woodson

**Deepest Usable Water**

Formation: Alluvium

Depth to Bottom of Formation: 15'

Check One: ☒ Old Well Being Converted

☐ Newly Drilled Well

☐ Well to be Drilled

Surface Elevation: 1070' feet Well Total Depth: 2300' feet Plug Back Depth: NA feet

Datum of top of injection formation: 2230' feet (reference mean sea level)

**Injection Formation Description:**

Name	top / bottom	perf / open hole	depth
Arbuckle	<u>2230</u> / <u>2300</u>	<u>Open Hple</u> at <u>2230</u> to <u>2300</u> feet	
		at to feet	

**List of Wells/Facilities Supplying Produced Saltwater or Other Fluids Approved by the Conservation Division:**

(attach additional sheets if necessary)

Lease Operator	Lease/Facility Name	Lease/Facility Description	Well ID & Spot Location
1. <u>Sample Oil, LLC</u>	<u>Smith</u>	<u>S/2 22-23-14E</u>	<u>#1 SW SE SE 22-23-14E</u>
2. <u>Sample Oil, LLC</u>	<u>Jones</u>	<u>SE/4 21-23-14E</u>	<u>#2A SE SE' SE 21-23-1E</u>
3. <u>"</u>	<u>"</u>	<u>"</u>	<u>4A SW NW SE 21-23-14E</u>

Producing Formation	Strata Depth	Total Dissolved Solids (if available)
1. <u>Cherokee Coal</u>	<u>1800</u> to <u>1890</u> feet	<u>15,000 mg/l</u> mg/l
2. _____	to _____ feet	_____ mg/l
3. _____	to _____ feet	_____ mg/l

Maximum Requested Liquid Injection Rate: 4000 bbls / day; or

Maximum Requested Gas Injection Rate: \_\_\_\_\_ scf / day. Type of Gas: \_\_\_\_\_

Maximum Requested Injection Pressure: 100 psig

**Well Completion**Type: ☒ Tubing & Packer ☐ Packerless ☐ Tubingless

	Conductor	Surface	Intermediate	Production	Tubing
Size		8 5/8"		4 1/2"	2 3/8"
Setting Depth		25'		2230'	2180'
Amount of Cement		8 sx		150 sx	
Top of Cement		0'		0'	
Bottom of Cement		25'		2230'	

If Alternate II cementing, complete the following:

Perforations / D.V. Tool at None feet, cemented to \_\_\_\_\_ feet with \_\_\_\_\_ sx.Tubing: Type Lined Seal-Tite Grade J-55Packer: Type AD-1 Tension Depth 2180'Annulus Corrosion Inhibitor: Type KCL Treated Water Concentration 5%List Logs Enclosed: Cement Bond Log**Well Sketch**

(To sketch installation, darken the appropriate lines, indicate cement, and show depths.)

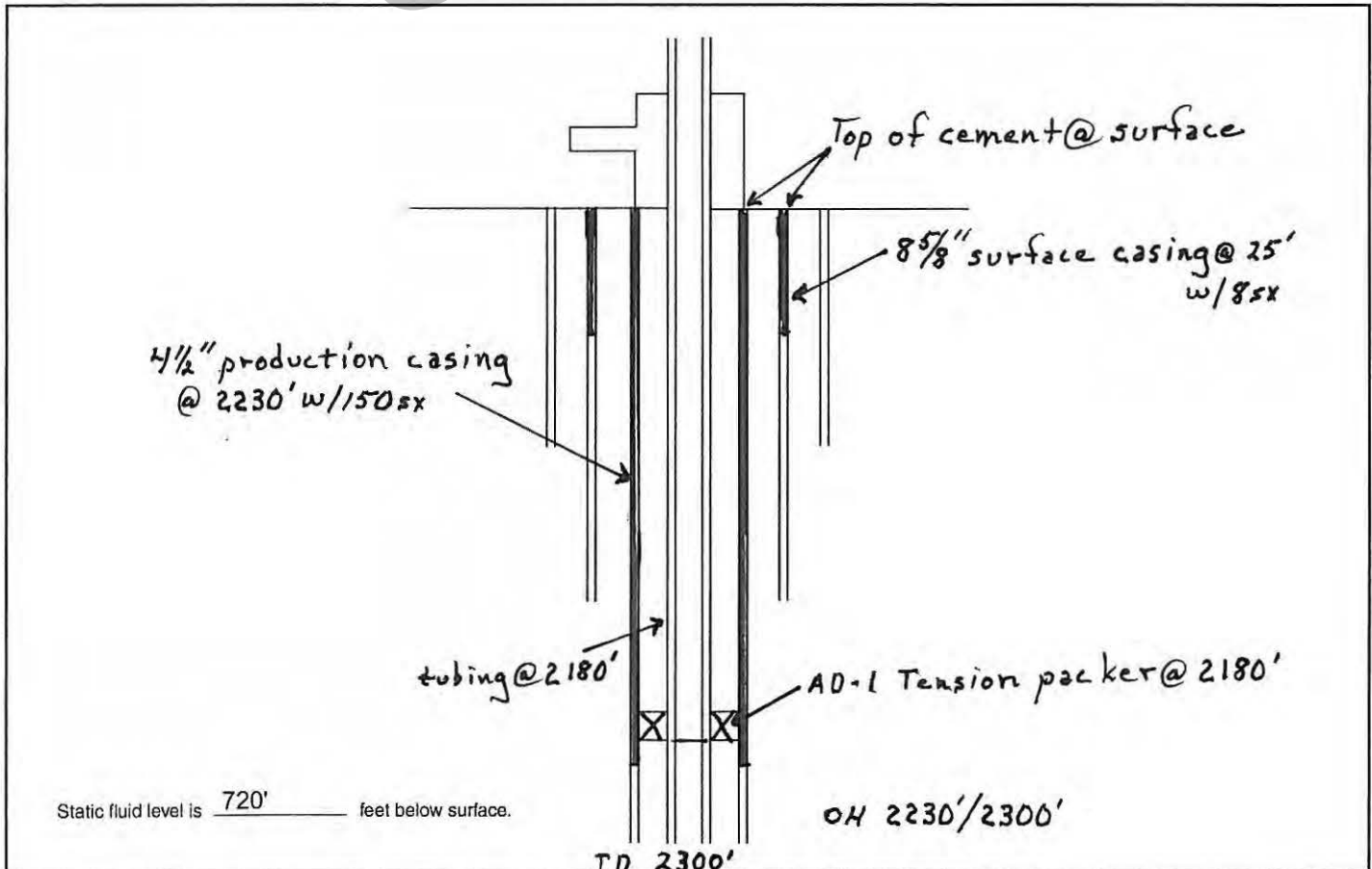

**Offset Operators, Unleased Mineral Owners and Landowners acreage**

(Attach additional sheets if necessary)

Name:

Legal Description of Leasehold:

Acme Oil, Co.

N/2 Sec. 22-23-14E

John Q. Public

NW/4 Sec. 23-23-14E

Jane Doe

SW/4 Sec 23-23-14E

Gusher Oil, Inc.

N/2 Sec 27-23-14E

R. Smith (landowner)

S/2 Sec 22-23-14E

I hereby certify that the statements made herein are true and correct to the best of my knowledge and belief.

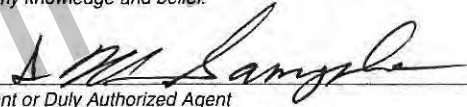
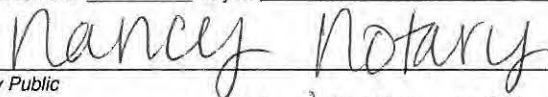
  
 Applicant or Duly Authorized Agent
Subscribed and sworn before me this 1st day of November, 2011
  
 Notary Public
My Commission Expires: 01 January 2099**Instructions:**

1. Fully complete application, including page 4 (*plat map*) showing subject well and all known oil, gas and input wells, including wells being drilled, inactive wells, or dry holes, within one-half mile. Show lease names and operators or unleased mineral rights owners of all lands within one-half mile. Show well numbers and elevations of producing formation tops.
2. Attach some type of log (*drillers log, electric log, etc.*).
3. Attach some type of verification of cementing for surface casing, longstring, D.V. tool, perforations, etc. (*Cement ticket and job log, bond log, etc.*)
4. Attach Affidavit of Notice.
5. Fill in schematic drawing of subsurface facilities including: size, setting depth, amount of cement, measured or calculated tops of cement for each of surface, intermediate (*if any*) and production casing; size and setting depth of tubing and packer; geological zone of injection showing top and bottom of injection interval.
6. The original and one copy of the application and all attachments shall be mailed to the State Corporation Commission, Conservation Division.
7. Deliver or mail one (*1*) copy of the application to the landowner on whose land the injection well is located and to each operator or lessee of record and each unleased mineral rights owner within one-half mile of the applicant well.
8. Approval of this application, if granted, is valid only as long as there are no substantial changes in operation set forth in the application. A substantial change requires the approval of a new application. **No injection well may be used without prior written authorization.**
9. All application fees must accompany the application.

**Plat and Certificate of Injection Well Location and Surrounding Acreages**

Operator: Sample Oil, LLC Location of Well: SW NW SE Sec. 22-23-14E  
 Lease: Smith 1650 feet from ☐ N / ☒ S Line of Section  
 Well Number: OWWO 'A' #1 2310 feet from ☒ E / ☐ W Line of Section  
 County: Woodson Sec. 22 Twp. 23 S. R. 14 ☒ East ☐ West

**Plat**

Show the following information: applicant injection well, all producing wells, inactive wells, plugged wells, and other wells within a one-half mile radius, all lease boundaries, lease operators, unleased mineral rights owners, well numbers, and producing wells producing formation tops.

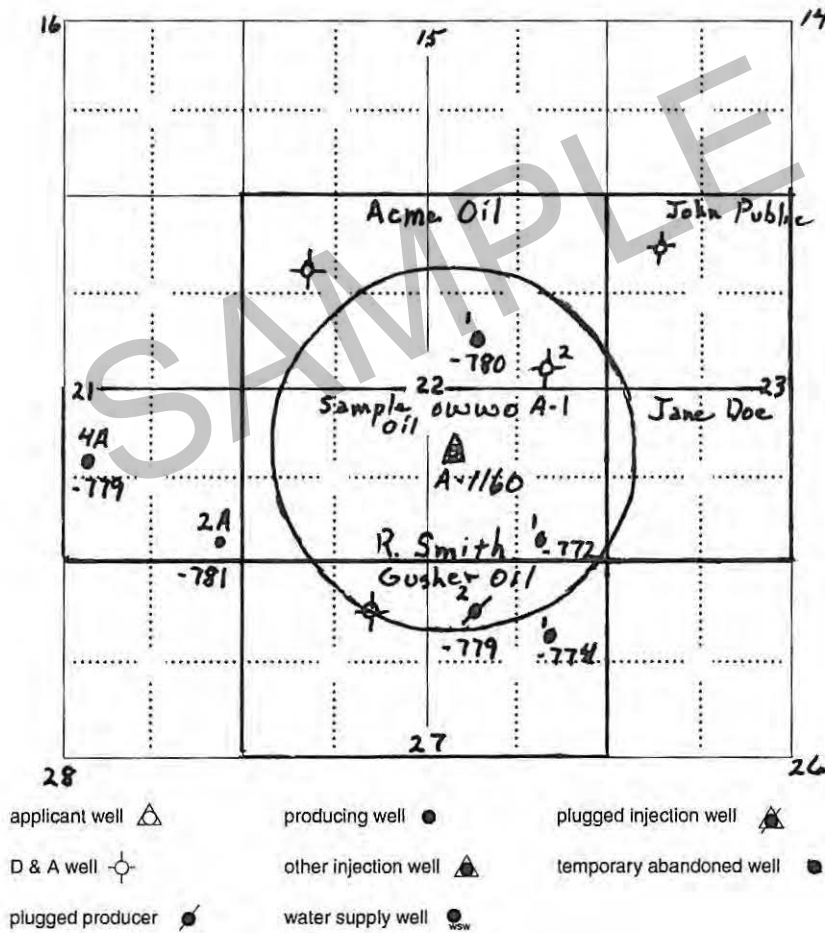

The undersigned hereby certifies that he / she is a duly authorized agent for Sample Oil, LLC, and that all of the information shown herein is true, complete and correct to the best of his / her knowledge.

J M Sample  
Applicant or Duly Authorized Agent

Subscribed and sworn before me this 1st day of November, 2011

Nancy Notary  
Notary Public

My Commission Expires: 01 January 2019

**Affidavit of Notice Served**Re: Application for: Sample Oil, LLCWell Name: Smith OWWO 'A' #1Legal Location: SW NW SE Sec. 22-23-14E

The undersigned hereby certifies that he / she is a duly authorized agent for the applicant, and that on the day 1st of January,  
2008, a true and correct copy of the application referenced above was delivered or mailed to the following parties:

Note: A copy of this affidavit must be served as a part of the application.

Name

Address (Attach additional sheets if necessary)

Acme Oil, Co.

c/o Banker's Trust, Anytown, KS 66000

John Q. Public

Box 82, Smalltown, KS 67000

John Doe

789 S. Bend, Box 456, Centerville, KS 67200

Gusher Oil, Inc.

PO Box 82, Bigtown, KS 67200

R. Smith (landowner)

123 S. Maple, Anytown, KS 66000

I further attest that notice of the filing of this application was published in the Yates Center News, the official county publication  
 of Woodson county. A copy of the affidavit of this publication is attached.

Signed this 1st day of January, 2008

Applicant of Duly Authorized Agent

Subscribed and sworn to before me this 1st day of January, 2008

Notary Public

My Commission Expires: \_\_\_\_\_

Protests may be filed by any party having a valid interest in the application. Petitions for protests shall be in writing and shall clearly identify the name and address of the protestant and the title of the application. The petition shall include a clear and concise statement of the direct and substantial interest of the protestant in the proceedings, including the manner in which the protestant may be affected, and the nature, extent, character and grounds of the protest. Protestants shall serve the protest upon the applicant by mail or personal service at the same time or before the protestant files the protest with the Conservation Division. Protests must be filed within 30 days of the publication notice of the application.